

# MDG: Measurement-Driven Guidelines for 802.11 WLAN Design

Ioannis Broustis  
Dept. of CS&E  
UC Riverside \*  
broustis@cs.ucr.edu

Konstantina  
Papagiannaki  
Intel Research, Pittsburgh  
dina.papagiannaki@intel.com

Srikanth V.  
Krishnamurthy  
CS&E, UC Riverside  
krish@cs.ucr.edu

Michalis Faloutsos  
Dept. of CS&E  
UC Riverside  
michalis@cs.ucr.edu

Vivek P. Mhatre  
Bell Labs, Bangalore, India  
vivekmhatre@alcatel-  
lucent.com

## ABSTRACT

Dense deployments of WLANs suffer from increased interference and as a result, reduced capacity. There are three main functions used to improve the overall network capacity: a) intelligent frequency allocation across APs, b) load-balancing of user affiliations across APs, and c) adaptive power-control for each AP. Several algorithms have been proposed in each category, but so far, their evaluation has been limited to: (a) each approach in isolation and, (b) simulations or small-scale testbeds. In this paper, we ask the question: what is the best way to combine these different functions? Our focus is to fully explore the interdependencies between the three functions in order to understand when and how to deploy them on a network. We follow a measurement-driven study to quantify the effects of three previously proposed optimization schemes (one for each category) on a relatively large testbed and in many different scenarios. Surprisingly, we find that blindly applying all the three optimization schemes is not always preferable; it can sometimes degrade the performance by as much as 24% compared to using only two of the schemes. We discover that there are explicit conditions that are conducive for applying specific combinations of the optimization schemes. We capture those conditions within a comprehensive framework, which we call MDG (Measurement-Driven Guidelines). While we derive such guidelines based on measurements on one experimental testbed, we test their applicability and efficacy on a second testbed in a different location. We show that our framework improves network capacity consistently across both testbeds, with improvements ranging from 22% to 142% with 802.11a, and 103% to 274% with 802.11g.

**Categories and Subject Descriptors:** C.2.1 [Computer - Communication Networks]: Network Architecture and Design; C.2.3 [Computer - Communication Networks]: Network Operations

**General Terms:** Algorithms, Measurement, Performance, Design, Experimentation, Verification

\*This work is supported in part by the NSF CAREER Grant No. 0237920 and the NSF NRT grant No. 0335302.

Permission to make digital or hard copies of all or part of this work for personal or classroom use is granted without fee provided that copies are not made or distributed for profit or commercial advantage and that copies bear this notice and the full citation on the first page. To copy otherwise, to republish, to post on servers or to redistribute to lists, requires prior specific permission and/or a fee.

MobiCom'07, September 9–14, 2007, Montréal, Québec, Canada.  
Copyright 2007 ACM 978-1-59593-681-3/07/0009 ...\$5.00.

**Keywords:** Wireless Local Area Networks (WLANs), IEEE 802.11, Frequency Selection, User Association, Power Control

## 1. INTRODUCTION

The emergence of highly dense wireless LANs is a consequence of: (a) the desire for ubiquitous coverage, (b) incremental and heuristic deployments and, (c) decreasing prices of access point (AP) hardware. The desire to ensure coverage with the best signal quality possible has led to environments with thousands of APs in urban areas and enterprises [1]. However, dense deployments can lead to high interference levels if resource sharing is not optimized.

To mitigate the interference in such networks, we can optimize operations by means of three functions: a) intelligent frequency allocation across APs, b) load-balancing of user affiliations across APs, and c) adaptive power-control for each AP. There have been techniques proposed for each of the above operations [2] [3] [4]. However, most previous efforts consider the optimization along each dimension (frequency, user affiliation or power) in isolation. In addition, the performance of each proposed method is typically evaluated on a different, small testbed and/or through simulations. Theoretical models and simulation studies are good for capturing bounds and trends, but not as good for quantifying the performance one should expect in practice.

The goal of this work is to explore the interdependencies between the three functions in order to maximize the benefits from their deployment. In particular, we want to: (a) understand the capabilities and benefits that one should expect from each optimization function, and (b) identify the conditions that are conducive for applying these functions in isolation or in combination. While all three functions manipulate the dense WLAN topology to maximize network capacity<sup>1</sup>, the tuning of the topology by one function may “impede” the application of another function. For instance, if one attempts to balance the clients across the APs, some clients may affiliate with farther APs than they would have otherwise. In that case, power control may not be able to reduce the power of the APs across the network, since such a power reduction would degrade the performance of these long AP-client links to unacceptable levels.

Our primary contribution is a framework that provides a comprehensive set of guidelines for the optimization of dense WLANs;

<sup>1</sup>Here, we use the term topology to refer to the network topology, as defined by links at the MAC layer. We also define the network capacity to be the aggregate network throughput under fully saturated traffic conditions and with the assumption that all clients of an AP receive the same throughput in the long-term.

we call our framework MDG (Measurement Driven Guidelines). As the name suggests, the foundation of our framework is an extensive measurement study on a large scale testbed, housed at the University of Cambridge, UK (Testbed A). We capture the topological conditions that render a WLAN amenable to optimization through appropriate combinations of the three functions<sup>2</sup>. We observe that the use of MDG increases the network throughput by at least 22%, as compared to other design decisions. We show that the derived guidelines increase the network capacity in a second testbed, at the University of California, Riverside [5] (Testbed B), thus demonstrating its effectiveness beyond our test environment. We highlight our main contributions below.

**1. An in-depth understanding of the synergy of the optimization dimensions:** We evaluate three existing algorithms, one for each dimension; the chosen schemes are among the best in their class. We implement and evaluate the algorithms, both in isolation and in all possible combinations, on Testbed A. We perform extensive measurements to study under what conditions a specific combination of the algorithms should be invoked to manipulate the topology of the deployment, in order to achieve optimal results. Our experiments demonstrate that in many cases, the use of one algorithm can often increase the efficacy with which another algorithm can be applied.

Interestingly we find that, *blindly applying all three algorithms can degrade performance*. While each algorithm in isolation achieves its optimization objective, in some cases, applying all three algorithms can lead to sub-optimal performance due to interdependencies among the algorithms.

**2. Designing MDG, a comprehensive optimization framework:** Based on our measurement studies, we derive the conditions under which the joint application of the algorithms are likely to yield significant performance benefits. In other words, we formulate a procedure that specifies guidelines on “*which*” of the algorithms should be invoked, in “*what*” order and “*under what conditions*”. Our framework can operate as a periodic reconfiguration process based on operational conditions, as we discuss later.

**3. Validating the MDG framework:** We validate MDG by applying it on a second WLAN (Testbed B). This network is completely different from our first testbed: it is deployed in another organization and under very different environmental conditions. We show that MDG provides the best observed performance on the testbed compared to any other combination of these optimization procedures.

**Our work in perspective:** We envision that our framework will be applicable in the following cases. First, MDG could be applied on a single dense WLAN, and the decisions on the operations could be taken either *centrally* (perhaps by a network administrator), or by the APs in a *distributed* way. Note that the affiliation decisions are typically taken by the users in their WLAN. Second, MDG could be applied in the presence of multiple overlapping WLANs. Here, the WLANs may either work cooperatively (they all run MDG and they are willing to share information) or not. In the latter case they will interfere with each other, but the application of MDG will succeed in improving network performance, given the constraints imposed by the uncooperative WLANs. In the former case, the cooperation is typically limited to frequency selection and power control, among the cooperative WLANs (see section 4). Note that, as we discuss later, our framework considers and tries to work around external interference.

<sup>2</sup>We use an experimental study with a large testbed to drive our guidelines, since we believe that this can provide a more realistic assessment of conditions in practice unlike simulation studies, simplified analytical models or observations on small scale testbeds.

The rest of the paper is organized as follows. In Section 2, we provide the relevant background and briefly describe the three algorithms considered in this work. We describe our first set of experiments, the observations, and the interpretations thereof in Section 3. Our proposed framework is derived in Section 4. We describe our validation process on the second WLAN deployment in Section 5. We discuss the limitations of our framework in Section 6. Our conclusions form Section 7.

## 2. BACKGROUND AND RELATED WORK

In this section, we first describe what one might expect in terms of default behaviors in dense WLANs. Next, we describe the three algorithms that we choose for optimizing each dimension (discussed in the previous section). Finally, we provide some details on other relevant work.

### 2.1 Default behaviors in WLAN deployments

Typically, each deployer could independently choose the frequency of operation of his/her WLAN. Thus, in a dense deployment, it is hard to determine the frequencies on which each AP operates under default conditions. There have been various frequency selection methods that have been previously proposed [6] [7] [3]; a deployer may choose one of these methods, a random frequency selection strategy or, simply a fixed frequency for all the APs in her/his network. Given this, we envision that in a dense setting, with a plurality of these individual deployments, the operational frequencies of the different APs will be somewhat random. In the default case, the user affiliates with the AP that offers the best signal quality (measured in terms of the received signal strength indicator or RSSI value). Under default settings, APs are unlikely to employ any form of power control.

### 2.2 Our choice of the optimization algorithms

Previous work has shown that the three optimization procedures (for frequency selection, power control, and, user association) can be cast under a unifying framework that relies on Gibbs sampling [2][3]. The problem formulation relies on the definition of an optimization criterion that is derived from a potential function, which conforms to the Gibbs framework [8]. The authors demonstrate that such a criterion exists for all three optimization procedures and can be proven to converge to a global optimum, through local optimization decisions, based on measurements that can be easily collected by APs and users.

**Optimality and Convergence:** All three algorithms rely on Gibbs sampling, an iterative procedure that was proven to lead to the global optimum of their respective criterion. Given that the procedure is iterative in nature, each algorithm is invoked multiple times throughout the network until convergence has been reached (the topology no longer changes). This final state of the network is the topology evaluated throughout our experiments. Notice that the specific algorithms used in this work are potential optimization strategies that may be adopted by a network operator, and that have been shown to work fairly well in real environments. *The focus of the paper, however, is not the optimality of the individual algorithms but a comprehensive framework that can combine them effectively.* We choose the three algorithms given that they can all be implemented within the Gibbs’ sampling technique. However, note that our framework, MDG, is applicable with other algorithms as well, as we discuss in Section 6.

In what follows we outline the optimization criteria that drive each of the chosen algorithms.

**Frequency selection algorithm (FS):** The Gibbs-based FS algorithm is described in detail in [3]. We denote the channel se-

lected by AP  $a$  as  $c_a$  and the total thermal noise and interference from non-802.11 sources at AP  $a$  as  $N_a$ . The power of the signal received at AP  $a$  from AP  $b$  is denoted as  $P_b(a)$ . If two APs  $a$  and  $b$  select channels  $c_a$  and  $c_b$  respectively, we capture their degree of orthogonality using function  $s_{CH}(a, b)$  which is equal to 1, when  $c_a = c_b$ , and 0 otherwise<sup>3</sup>. Based on the above notation, minimization of total interference across the entire network can be formulated as the minimization of the energy function:

$$\mathcal{F}_a = N_a + \sum_{b \neq a} s_{CH}(a, b)(P_b(a) + P_a(b)).$$

The optimization objective aims to allocate frequencies to APs such that (i) the total amount of noise across the entire network and, (ii) the amount of power sensed at each AP from its co-channel APs together, are minimized. Assuming symmetry in power and attenuation, the above equation can be simplified to:

$$\mathcal{F}_a = N_a + \sum_{b \neq a} 2s_{CH}(a, b)P_b(a).$$

Therefore the global objective can be broken down into locally measurable objectives: the term  $N_a$  is the ambient noise around AP  $a$ , and the term  $\sum_{b \neq a} s_{CH}(a, b)P_b(a)$  is the amount of power received by AP  $a$  from all other neighbor APs, operating on the same frequency. [3] showed that this optimization problem can be effectively solved using the Gibbs sampler; the solution is proven to converge to a global optimum. Given its simplicity it forms the basic algorithm that we test in the frequency selection space. Implementation details are provided in Section 3.

**User association algorithm (UA):** The UA algorithm is described in detail in [3]. This algorithm uses a philosophy that is similar to that in the previous case, but aims to achieve the state of minimal potential delay as defined in [9]. The algorithm is amenable to a fully distributed implementation using Gibbs sampling and can alleviate congestion by balancing the load across a larger set of APs. Within the user association formulation the objective aims at minimizing the amount of time that a user needs to wait until the reception of a unit of information from its associated AP. Assuming fully saturated traffic conditions, i.e., each AP always has a packet to send to each one of its users, the long-term throughput obtained by each user  $u$  associated with AP  $a$  has been shown to be:

$$r_u = \frac{M(a)}{\sum_{v \in \mathcal{U}_a} d(v)} = \frac{M(a)}{\sum_{v \in \mathcal{U}} s_{AP}(u, v)d(v)}, \quad (1)$$

where  $\mathcal{U}_a \subseteq \mathcal{U}$  is the subset of users associated with AP  $a$  (set  $\mathcal{U}$  denotes all the users in the network), and  $M(a)$  is the fraction of time AP  $a$  is able to access the medium given its co-channel devices; sharing the medium with the co-channel devices will effectively limit its capacity to be a fraction of its nominal value. In addition,  $d(v)$  is the data unit transmission delay of user  $v$ , and depends on the instantaneous transmission rate to user  $v$  [3]. In fully saturated downlink conditions, the max-min fair allocation of bandwidth in the cell implies that each user will get the same throughput, which is inversely proportional to the “sum of transmission delays  $d(v)$  for each user  $v$  associated with the same AP as  $u$  (determined through function  $s_{AP}(u, v)$ ). This latter metric is called *Aggregated Transmission Delay (ATD)* [3]. The minimization of the potential delay can then be formulated as the minimization of the following energy function:

$$\mathcal{E}((a_u)_{u \in \mathcal{U}}) = \sum_{u \in \mathcal{U}} \frac{1}{r_u}, \quad (2)$$

<sup>3</sup>This function can be a fraction between 0 and 1 for partially overlapped channels.

where,  $r_u$  is the *long term throughput* of user  $u$  as given by Eq. 1. Notice that there is a delicate difference between minimizing potential delay and maximizing capacity. Under our selected criterion solutions where individual user throughput,  $r_u$ , tends to zero will be undesirable; something that could not be prohibited if our optimization criterion was the maximization of the sum of throughputs across the network. In other words, our optimization criterion targets states of high capacity, while ensuring fairness. [3] showed that this optimization criterion is equivalent to each user  $u$  optimizing the following local energy function:

$$\mathcal{E}_u = \frac{1}{M(a_u)} \left( K_a \cdot d(u) + \sum_{v \in \mathcal{U}_a} d(v) \right) \quad (3)$$

where,  $K_a$  denotes the number of users associated with AP  $a$ . In Eq. 3,  $K_a \cdot d(u)$  is the additional potential delay that all the other clients of AP  $a$  will experience, due to the association of user  $u$  with AP  $a$ , and  $\sum_{v \in \mathcal{U}_a} d(v)$  is the delay that client  $u$  will experience because of  $a$ 's existing users. This local energy only depends on the state  $a_u$  of user  $u$  and that of its neighbors. We assume here that for all  $a$ , the AP channel access time  $M(a)$  is not a function of the state of the users, which is reasonable under our saturated downlink traffic assumption as long as each AP has at least one user.

**Power control algorithm (PC):** Power control has only recently attracted the interest of the 802.11 WLAN research community. [2] and [4] show that power control in 802.11 WLANs needs to preserve symmetry in the contention domains. They also show that symmetry is preserved only when the product of transmission power and the Clear Channel Assessment (CCA) threshold<sup>4</sup> for each AP is constant throughout the network. We employ the solution proposed in [2]; the proposed algorithm enables the exchange of appropriate information (by means of Beacon frames) among APs to allow them to optimally tune the transmission power and the CCA thresholds, such that symmetry is preserved. The parameters are tuned by each AP so as to achieve the state of minimal potential delay. The solution has been shown to lead to up to three times improvement with respect to a case where no power control is employed via experiments on a small scale testbed. For more details please see [2].

Note here that no client-side information is needed for FS, UA or PC. The APs measure all the channel gains, and calculate delays and loads. The clients just need to apply the optimum settings determined by the AP, and this is readily done today.

## 2.3 Other Relevant Work

There have been various other frequency selection algorithms that have been previously proposed [6] [7]. With the LCCS (Least Congested Channel Search) scheme, in [7], the AP chooses the least congested channel. The proposal in [6] is to hop between various channels to minimize co-channel interference. The operation of the FS algorithm is similar to that of LCCS. In [10], Mishra et al. propose a framework for client-based frequency allocation in WLANs; this combines the dimensions of frequency selection and user association into a unified framework.

The work that is most related to our work is SMARTA [11], which considers the problem of joint channel allocation and power control in WLANs. SMARTA requires a central controller, which tries to optimize a utility function, using a set of measurements that are performed by the APs. The central controller constructs and periodically updates a conflict graph; the APs constitute the nodes of

<sup>4</sup>The CCA threshold defines the RSSI value below which, receptions are ignored with regards to carrier sensing.

the graph. Based on the conflict graph, the controller jointly generates optimal channel assignments and power control levels for the APs. First, unlike SMARTA, our framework MDG can be implemented in a completely decentralized manner. Second, it includes the user-association component in addition to frequency selection and power control. Finally, MDG also provides detailed guidelines on “when” a specific combination of operations (FS, UA and/or PC) is to be invoked in a “generic” dense WLAN deployment.

### 3. DERIVING DEPLOYMENT GUIDELINES

In this section, we describe the experiments that we perform on Testbed A to understand the interdependencies between the three optimization dimensions. We begin with a description of the testbed and subsequently discuss experiments with the three optimization algorithms (FS, UA and PC from Section 2) in isolation and in combination.

#### 3.1 Testbed Description and Deployment Strategy

Testbed A consists of 21 APs and 30 clients, and spans the upper two floors of the William Gates Building, at the University of Cambridge, UK. The deployment is depicted in Fig. 1. The walls in the building are wooden without any metallic support in between. The nodes are Soekris net4826 boxes [12] and run a Debian Linux distribution with kernel version 2.6.16.19. Nodes are equipped with the Intel 2915a/b/g wireless cards, which are controlled by a prototype version of the Intel ipw2200 driver and firmware. Each card is connected to two 5-dBi gain, external omnidirectional antennas. We use both the *main* and *aux* signal inputs of the Intel card for diversity. We have modified the ipw2200 driver and firmware to implement our three optimization algorithms. We provide implementation details later in this section.

**Choosing AP locations:** In Testbed A, 12 of the APs are installed in the building’s network closets following the existing WLAN deployment. These APs form a 2x3 grid topology in each of the two floors. The positions of the remaining 9 APs were selected after a set of measurements and placed uniformly to ensure maximal coverage.

**Experimental Settings:** Our goal is to perform extensive measurements with the three algorithms, FS, UA and PC and combinations thereof. Our experiments were performed with both 802.11a and 802.11g and late at night; the time ensured that the contention and interference from co-located WLANs is limited<sup>5</sup>. All nodes by default set their transmission power to the maximum (20 dBm) and their CCA thresholds to -80 dBm. Each client receives fully-saturated downlink UDP traffic for two hours, from its AP. We have selected only downlink traffic for our experiments, since traffic is predominantly downlink in most WLAN deployments. We use the *iperf* bandwidth measurement tool. During each experiment, a central testbed server periodically stores the following information:

- The clients that are activated in the experiment, and the time at which each activation takes place.
- The network topology specifying the clients that are affiliated with each AP at the sampled instance.
- The channel, the transmission power and the CCA of each AP.

Note that each AP implements the Intel proprietary rate adaptation algorithm, adapting the transmission rate of the AP to each client

<sup>5</sup>The performance of the schemes in the presence of interference from co-located WLANs is examined in Section 5-3.

according to the quality of the channel. In the presence of rate adaptation it has been shown [13], and we have verified in our testbed, that all clients will receive the same long term throughput under fully saturated traffic conditions.

#### 3.2 Frequency Selection

We first evaluate and experiment with the FS algorithm. The objective of the FS algorithm is to assign frequency channels to the different APs, such that the interference between the APs is minimized. In this section, we only consider the FS scheme in isolation and we combine it with other algorithms later. The key observations from our experiments are:

- Neighboring APs may interfere with each other, even when set to orthogonal channels in IEEE 802.11a. Thus, to eliminate interference, neighboring APs with a mutual RSSI > -40 dBm must choose frequencies that are separated by at least 40 MHz with 802.11a.
- The use of the FS algorithm almost always improves (and never hurts) the performance compared to that achieved with default behavior.
- We observe that, loss of beacon messages affects the channel selection decisions negatively. The beacons are lost either due to poor link quality, AP overload (when they may not even get sent out), or insufficient scanning times.

We first present some implementation details specific to FS.

**Implementation Details:** We activate all APs sequentially in random order. At start-up, each AP starts running the FS algorithm, which is an iterative process, until the channel decisions do not change for a set of iterations. The clients are then activated sequentially and they choose their APs based on the strongest received signal (i.e., the UA algorithm is not activated). Note that in Testbed A, FS converges in 2 iterations (each iteration is scheduled at instances that are separated by exponentially distributed periods with an average value of 30 mins). The FS algorithm is implemented in the AP driver and firmware. In particular, the following features were implemented:

**1. Gathering information with regards to each channel:** Each AP passively scans each channel to discover neighbor APs. On each channel, the AP measures the strength (RSSI) of the received signal from each neighboring AP. The RSSI values are then added to compute the total received power on the current channel. Note that APs are configured to only scan the orthogonal channels under both 802.11a and 802.11g.

**2. Interference and co-located WLANs:** The AP driver, by default, measures the strength of the received signals from all APs, irrespective of whether they belong to the same WLAN or not. We opt to run the experiments at night to avoid interference from co-located WLANs. This has two advantages: our results are easier to reproduce and interpret. Note that, before initiating our experiments, we monitor the medium and we verify that there is no data traffic from external WLANs. Hence, we have modified the AP driver to ignore the beacons from inactive APs of other WLANs, in the channel selection process.

Our experiments and the observations thereof are described next.

**a. The FS algorithm in isolation is always beneficial in a dense WLAN:** We quantify the performance improvements with the FS algorithm. For comparison, we consider two different approaches: (i) all APs are on the same channel<sup>6</sup> and, (ii) a chan-

<sup>6</sup>Here we use channel 1 for 802.11g, and channel 56 for 802.11a in our experiments. We also experimented with other channels, and the experiments verified the reported results.

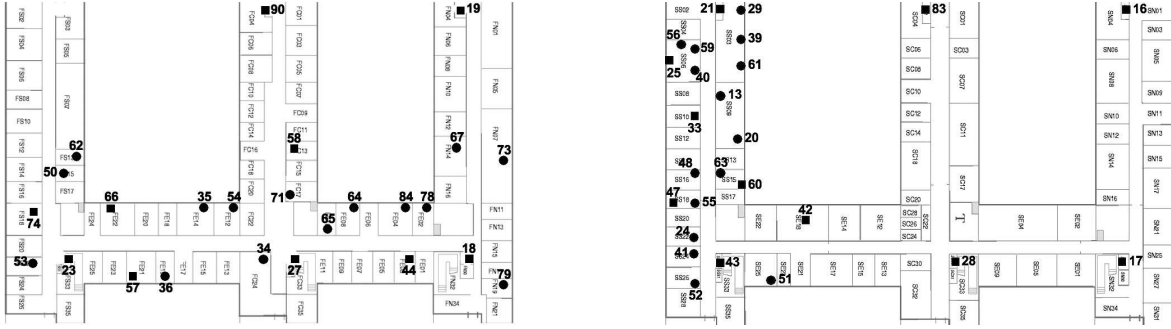

**Figure 1: Testbed A: deployment on the second floor (left) and the third floor (right) of a 3-floor building. Clients are represented by circles, while APs by squares.**

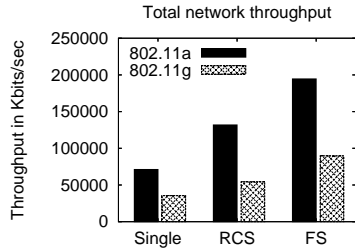

**Figure 2: Comparison between FS in isolation, RCS, and single channel selection, for 802.11a as well as 802.11g.**

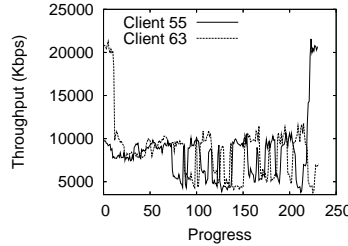

**Figure 3: Interference from AP 60 to the cell of AP 47. The X axis shows the progression in time, in units of 30 sec.**

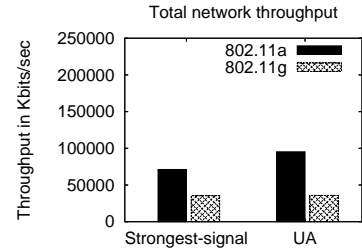

**Figure 4: Comparison between UA in isolation, and strongest-signal affiliation, for both 802.11a and 802.11g.**

nel selection algorithm, which we call RCS algorithm (for Random Channel Selection), where each AP randomly selects one of the orthogonal channels, which arguably approximates real network deployments (see Section 2-A). We expect that the FS algorithm will perform better since it selects the channel with the farthest possible reuse. In what follows, we will quantify performance using the sum of throughputs achieved by all clients across the network, a metric we will also call as the “network capacity”. Fig. 2 shows that FS outperforms RCS by 48% in 802.11a and by 65% in 802.11g.

**b. Loss of beacon messages affects the decisions of the FS algorithm negatively:** In many cases, we observed co-located APs with the same frequency, although such frequency overlaps could have been avoided. An AP follows a scanning process, where it listens for beacons from APs to choose its operating frequency. When an AP misses beacon messages from its neighbor APs, it can end up selecting a frequency already in use. Missing a beacon could be a consequence of: (a) poor link conditions, (b) small scanning duration (band dwell duration), and (c) lack of timely beacons from neighbors [14]. To improve the selection, the FS algorithm can base its decision on a sufficiently large scanning interval, and on more than one scanning cycles (recall that each AP iterates the FS algorithm until convergence is reached).

**c. The FS algorithm and frequency utilization:** Testbed A is fairly dense in terms of AP placement: the average AP degree is 5 and the maximum is 9, counting only AP-to-AP links. We observe that, with FS, only 6 channels<sup>7</sup> were used with 802.11a and that was enough to isolate overlapping APs.

Does the FS algorithm miss an opportunity to further improve its performance by not using the unused frequencies? The answer is no. We conducted additional experiments using the unused or-

thogonal channels. In fact, we modified the driver to use an additional channel from the remaining set. In particular, we identified APs with the same frequency, and used the unused frequencies to set them to different frequencies. Our measurements indicate that the throughput improvement was minimal, approximately 0.06%. In contrast, with 802.11g, all three available orthogonal channels were used, and that was not enough to completely isolate the APs. Clearly, the density and the structure of the topology defines the number of necessary frequencies.

**d. APs may suffer interference from each other, even when set to orthogonal 802.11a frequencies:** The FS algorithm may assign two *consecutive* orthogonal 802.11a channels to two neighbor APs under the assumption that they do not interfere with each other. As an example, in a certain experiment AP47 selected frequency 5.26 GHz and a close neighbor AP60, selected frequency 5.28 GHz. We observed that when AP60 sent traffic, the throughputs enjoyed by AP47’s clients dropped dramatically (Fig. 3). We repeated the same experiment with a set of Atheros-based WiFi cards (EMP-8602 6G), and observed the same behavior (thus, the behavior is not hardware specific). We ensured that the observed drop in Fig. 3 was not due to interference from APs in collocated WLANs; AP47 was the only AP using frequency 5.26 GHz in the neighborhood. The spillage between consecutive orthogonal channels is approximately on the order of -38 dB [15]. When nodes on such consecutive channels are close, there is very little path loss and thus, this leakage is strong enough to activate the carrier sensing at the MAC layer.

**e. Going beyond orthogonality in selecting frequencies:** Our experiments suggest that APs whose mutual RSSI is on the order of -40 dBm, should be assigned channels that are separated by at least 40 MHz (as an example, channels centered at 5.22 GHz and 5.26 GHz). We observed that with this separation even very closely-located APs (RSSI higher than -35 dBm) never interfere with each

<sup>7</sup>There are 8 non-overlapping 802.11a channels for North America: 36, 40, 44, 48, 52, 56, 60 and 64.

other. We are interested in observing the difference in performance, if the selected (by the FS algorithm) set of 802.11a channels is rearranged among the APs, such that the above frequency separation is applied for closely-located APs. For this, we first run the FS algorithm until convergence is reached. We then manually perform a channel reassignment, such that APs that are in close proximity are set to distant frequencies. We also ensure that APs that are likely to interfere are on different channels. We compare the performance of this refined assignment with that of the FS algorithm and we observe an improvement of 24% in the network throughput on average. Note that this is also an indication of why experimenting with large-scale testbeds is beneficial. In a small-scale testbed, the few APs are more likely to select channels with frequency separation larger than 40 MHz, and thus, we would not have observed this phenomenon.

### 3.3 User Association

Here, we seek to evaluate the benefits of the UA algorithm. We compare this with a strategy where clients affiliate with the AP that provides the strongest signal, which is the default behavior as explained earlier. We consider the UA algorithm first in isolation, and second in conjunction with the FS algorithm. The key observations based on these experiments are:

- Load balancing of user affiliations is beneficial only when the inter-AP contention is limited.
- The use of the UA algorithm improves throughput as compared to default behavior (strongest-signal based affiliation).
- Poor AP-to-client link quality can negatively impact UA.

**Implementation Details:** The activation procedure is the same as in the previous case i.e., we first activate all the APs, and then activate the clients randomly, one every 100 seconds. Note that in testbed A, UA converges in 5 iterations on average (per client). The UA algorithm requires modifications in the AP driver and firmware, as well as in the client driver.

**1. Computing the ATD metric:** At the firmware level, we measure the time between queueing a packet at the MAC layer until an ACK (from the client to which the packet is destined) is received. The driver retrieves this duration from the firmware and calculates the average transmission delay to serve one round of users[3, 16].

**2. Assessing the channel access time:** The channel access time is the fraction of time for which the AP has access to the medium; this depends on the level of contention in the neighborhood. At the firmware, we measure the number of slots that the AP is: (a) transmitting or receiving (b) idle and, (c) in the back-off state. The measurement period involves 5 transmission/reception events. These measurements are used by the driver for estimating the channel access time, i.e. the fraction of a reference period that the AP succeeds in gaining access to the medium, given its contenders.

**3. Beacon modifications:** We modify the beacon template to include the ATD of the AP, the number of clients associated with the particular AP and the channel access time measured at that AP.

**4. Client AP selection:** The client driver is modified to recognize the additional Beacon fields and use them in its association decision according to Eq. 3.

We present our experiments and their interpretations.

**a. Inefficiencies in scanning for APs:** In our experiments, we observed in several cases that clients remained affiliated to an AP, while they should have associated with less-loaded neighbor APs. We attribute this to lost beacons during the scanning phase (due to small band dwell times and/or due to poor link qualities). Thus,

the UA implementation should base its decision on more than one scanning cycle to avoid sub-optimal affiliation decisions.

**b. In isolation, UA is beneficial only for 802.11a and not for 802.11g in a dense WLAN:** First, we consider the use of a single frequency channel with the UA algorithm. There are two factors that affect the throughput that a client can receive from an AP: (i) the load of the AP, and (ii) the contention among the neighboring APs. By associating with a lightly loaded AP, a client can expect an improvement in performance. However, if the newly selected AP has to contend with many other neighbor APs, the change may not improve the performance for that client. With 802.11g, cells are larger and can only select from a smaller number of channels, while, with 802.11a, the cell size is smaller and the number of channels is higher. Due to this, with 802.11a, UA provides about a 34% improvement with respect to the strongest-signal affiliation decision, while with 802.11g, the improvement is only about 1%, as shown in Fig. 4.

Without the UA algorithm, a client associates with the AP that offers the best RSSI value. This, however, results in overloading some APs, while other APs are under-utilized and in some cases remain unused. With the UA algorithm, each client associates with the AP that provides the minimum long-term delay as per Eq. 3, which considers the load of an AP in addition to the signal quality from the AP. We observed that without UA, 4 APs had to serve 5 clients each out of the 30 clients while 8 of the 21 APs had no clients at all! With UA, each APs had to serve 2 clients on average, while at most 3 clients were associated with an AP.

**c. When both FS and UA are applied, the overall network throughput becomes much higher than if one were to add the throughputs in the isolated cases:** Results from an indicative experiment are shown in Fig. 5; the CDF of the client throughputs based on all performed experiments is shown in Figure 6. The observed boost in the throughput is due to the fact that UA is able to exploit the significant reduction in the interference experienced by the clients and the contention for the medium between APs, due to FS. Since 802.11a supports a large number of orthogonal channels (as compared to 802.11g) the improvements are more dramatic in this case.

### 3.4 Power Control

Next we consider the power control algorithm, PC, which was outlined earlier. We evaluate PC in isolation, as well as in conjunction with the other two algorithms. Our key observations are summarized below:

- Power control is only beneficial if intelligent frequency selection is first applied on the network.
- The benefits are minimal in 802.11a since frequency selection resolves most of the contention for the considered density of deployment; the benefits are more pronounced with 802.11g.
- Blindly applying the three algorithms might hurt the performance; the choice of what to apply should be carefully assessed.

**Implementation Details:** We perform modifications to the driver to allow APs to exchange information through their Beacon frames in order to identify optimal transmission power and CCA values (as per the PC algorithm [2]). The clients use the same transmission power and CCA as their AP. Note that PC converges in 200 iterations, in Testbed A (each iteration taking place at the Beacon time granularity, i.e., 100 ms).

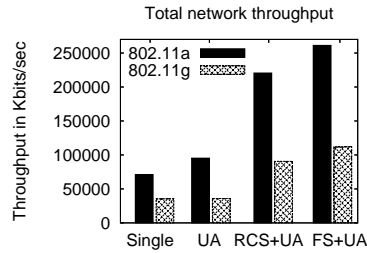

**Figure 5: UA provides higher benefits when contention and interference are low.**

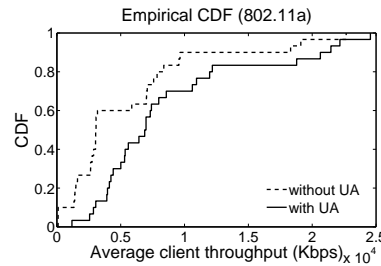

**Figure 6: Empirical CDF of client throughputs, with and without the UA, for the case of FS, in 802.11a.**

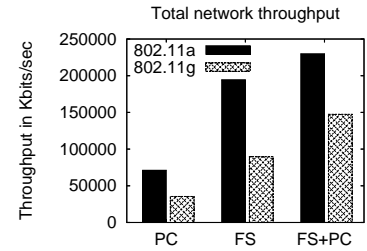

**Figure 7: Since contention and interference are high in 802.11g, power control provides higher benefits.**



**Figure 8: Case (a): AP-client link is strong ( $> -55$ dBm) and AP-AP link is weaker by at least  $k$  dBm. Case (b): AP-client and AP-AP links are strong ( $> -55$ dBm); they only increase their CCA. Case (c): AP-client link weaker than AP-AP link; PC cannot shrink cells. Case (d): AP-client links are quite poor; no reduction in power or increment in CCA is possible. Case (e): AP-client links not much stronger than AP-AP links; isolation is impossible.**

We present our experiments and observations below.

**a. Understanding when PC can shrink and isolate cells:** The intent of the PC algorithm is to tune the transmission power and CCA settings in order to balance the reduction in interference to other co-channel APs, and the reduction in signal quality to the weakest client, while ensuring symmetry in the contention domains across the network [2]. Our first set of experiments determine the conditions under which PC can improve performance. Our observations lead to classifying the relationship in terms of signal-strength between AP-client and AP-AP links into five cases. In the first two cases, PC is able to tune its power/CCA levels to improve the network capacity. In the other three cases, its application cannot provide any improvement. In other words, the optimal strategy is to apply the default<sup>8</sup> power/CCA settings. To simplify the following descriptions for each case, we consider two neighboring APs, with one client each. Note that we will refer to the cases below when we discuss the PC algorithm in the rest of this document.

**Case (a):** The AP-client link is strong ( $RSSI > -55$  dBm) and the AP-AP link is weaker by  $k$  dBm ( $k = 15$  to  $20$  dBm for our cards) (Fig. 8a). In this case the APs manage to shrink their cells to the extent that they transmit concurrently. Since the inter-AP links are much weaker than the AP to client links, each AP can reduce its transmission power without degrading the performance to its clients. In our experiments, we observe that the difference in the link quality between the AP-client link and the AP-AP link ought to be on the order of 15 dBm with our cards; if this difference is lower, then we observe that the links conform to case (e).

**Case (b):** Both AP-AP and AP-client links are strong ( $RSSI > -55$  dBm). In this case, a complete isolation between cells is impossible with a reduction in power (Fig. 8b); thus, the APs transmit with maximum power. However, we observe that the APs can increase their CCA thresholds to a high value and thereby ignore each other's signals, i.e., carrier sensing is ignored. Upon closer inspection, we determine that the clients were able to receive a throughput that was higher, than what they would have received if the two APs were operating in mutual exclusion (due to carrier sensing). This

<sup>8</sup>The default power is the maximum permissible power by the WiFi cards. In our system, the default CCA threshold is at  $-80$  dBm.

setting (where APs increase their CCAs only) has also been shown to enhance performance in [17].

**Case (c):** The AP-AP link is stronger than the AP-client link, irrespective of the absolute RSSI values. Here the PC algorithm cannot shrink the cells (Fig. 8c) and hence, the default power settings are also applied. Furthermore, since increasing the CCA threshold to isolate the neighbor AP would result in the isolation of some of its own clients, the AP does not do so.

**Case (d):** The AP-client link is weak ( $RSSI < -60$  dBm) and the AP-AP link is even weaker (Fig. 8d) by  $k$  dBm ( $k > 20$  dBm). In this case the AP-client link cannot sustain a high rate if the power is reduced; it is essentially isolated from the network if the CCA is increased beyond its default setting.

**Case (e):** The AP-client link is stronger by  $k$  dBm than the AP-AP link, where  $k < 15$  dBm. If the AP-AP link is comparable to the AP-client link (say 12 dBm difference) then, by either reducing the transmission power or by increasing the CCA threshold, an AP cannot effectively isolate the two cells (Fig. 8e). Thus, PC sets default settings in this case.

Note that in our testbed we mainly observe cases (a), (c) and (e); the cases pertaining to (b) and (d) are rarely observed and only for short time periods. These cases are not apparent if one were to do limited experimentation with small testbeds. With such testbeds, the possibility that the APs are far apart with few clients in their close proximity, is high. This would suggest that irrespective of whether or not FS is used, the links always conform to case (a) and thereby, it would seem that PC is always beneficial.

**b. PC may not provide benefits without FS:** First, we consider PC with a single frequency channel, and user association as per the strongest received signal. We observe that without FS, links that fall under cases (c) and (e) (described above) always exist. Thus, PC is not able to shrink the co-channel cells. Since the algorithm mandates that APs that belong to the same connected network must have the same product of power and CCA to avoid starvation effects [2], all the APs will use the default power and CCA settings in this case. This observation holds for both 802.11g and 802.11a.

**c. Without FS, PC may not provide benefits even in conjunction with UA:** In our experiments, with the UA algorithm the AP-

client links could become worse than before, since now some of the clients choose APs with lower loads even if the signal quality is poorer. Hence, even more links that fall under cases (c) and (e) may be created. This makes it even harder for PC to shrink overlapping cells.

**d. Frequency Selection aids PC:** Recall that frequency selection assigns different channels to neighboring cells so that APs with the same frequency are farther away and the interference (signal strength) is reduced. This provides an opportunity for PC to further reduce contention, since links now conform to the conditions of case (a) described above.

**PC provides further improvements after intelligent frequency selection:** The application of PC after FS can successfully yield smaller cells and, thus, eliminate or reduce overlaps between cells. In particular, since the FS algorithm may not completely isolate cells, overlaps do exist. The use of PC helps significantly, since many of these links conform to the conditions of case (a). These benefits are more pronounced in the case of 802.11g, where, given the long range and small number of orthogonal channels, FS cannot completely isolate cells by itself. Although the benefits are less pronounced with 802.11a, given that it has a larger number of orthogonal channels and shorter links, they are significant. We observe that, with 802.11a, there were only 2 pairs of interfering APs that shared the same channel; PC is applied on these co-channel cells only. Fig. 7 depicts the observed performance benefits from PC with FS, for the different 802.11 modes of operation. We wish to point out that PC was unable to shrink co-channel cells when administered in conjunction with RCS (10 different random channel settings were considered). We observed that in all 10 topologies, cases (c) and mostly (e) were present. We expect however, that there exist random channel allocations where PC is likely to yield benefits.

This is another implication of the importance of using large-scale testbeds. With a small-scale testbed, one cannot quantify the extent to which partial overlap among cells still exists after PC.

**e. Blindly applying all three algorithms is not a “good idea”:** Due to the interdependencies of the algorithms, we need to carefully select which algorithms to apply to maximize the performance. For example, the PC algorithm provides improvements only in cases (a) and (b) mentioned above. However, the application of UA might create links that conform to cases (c) and/or (e) and this causes the PC algorithm to provide default power/CCA settings. The results with such a scenario are depicted in Fig. 9, for 802.11g; by applying all three algorithms the achieved network capacity is 24% lower than if we apply FS and PC only. Note however, that such an effect may not always occur. Our measurements indicate that the UA algorithm, in some cases results in a few, relatively strong AP-client links. This is due to the fact that the clients with weak links are likely to migrate to neighbor APs which are typically on a different channel. Thus, their old APs will be left with fewer, stronger AP-client links. In fact, by repeating the same experiment on a different day, we observed that the combination of the three algorithms boosted the network capacity further: by 274% with respect to the default case (and 22% as compared to the next best combination) for 802.11g, and 142% for 802.11a.

#### 4. A FORMAL METHOD FOR ENABLING THE ALGORITHMS

In this section, we formulate our comprehensive network configuration framework, MDG, which is based on our observations from the previous section. MDG can be thought of as a decision framework, which takes a small set of measurements as input and

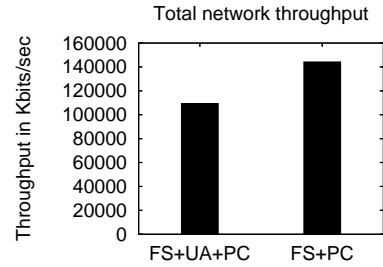

**Figure 9: Blindly applying all algorithms may degrade the performance.**

decides which algorithms to apply and in what order. The goal of MDG is to apply algorithms only if specific conditions, which suggest that the algorithms will provide performance benefits, are met. FS is considered first, since the channel allocation determines the channel access time for each AP (considered by UA), as well as the AP-AP link strengths (considered by PC). We elaborate on why we start with FS, in section 6. Note here that although the flow chart reflects the algorithms used in this study, we expect MDG to be able to guide other optimization algorithms, as we discuss in Section 6. MDG is represented as a flow diagram in Fig. 10 and is described in detail below.

**Inputs to MDG:** MDG requires the following measurement-based information to make its decisions:

1. Whether overlapping cells using the same channel exist so as to apply FS.
2. Whether overloaded APs exist so as to run UA.
3. Whether or not AP-client and AP-AP links fall under cases (a) and (b), described in section 3-E, so as to apply PC.

Note here that if MDG is jointly applied by collocated cooperative WLANs, UA only permits clients to affiliate with the APs of their WLAN. For clarity we do not account this case in our flow diagram.

**MDG Decision States:** We describe the decision states in more detail below.

**Checking if FS, PC and UA are beneficial: Steps (1) and (2).** These steps are based on the following observations (i) if no AP contention exists, FS and PC are unnecessary and (ii) if the load in the network is perfectly balanced among the APs, UA is unnecessary. Step (1) is related to the first observation and Step (2) to the second. Note that our criterion for invoking UA, assumes uniform demands across users, and tests if an AP has at least two more clients than any other AP. (Note that, if the user demands for service vary, we could define the load of an AP to reflect the bandwidth requirements instead of the number of clients).

**Choosing between PC and UA: Steps (3) and (4).** If the FS algorithm resolves any remaining contention (Step (3) in the flow chart), then PC is not needed; we only need to check if UA is required as per Step (2). If there is still contention on any channel (due to the existence of co-channel devices), then the further steps depend on whether the network employs 802.11a or 802.11g at Step (4). For the case of 802.11a, we proceed to Step (6a), while for the case of 802.11g we proceed to Step (5a). The justification behind such a choice is provided below.

**The case for 802.11a: Steps (6a) and (6c).** These steps are based on a few key observations from Section 3. First we recall the following two observations: (i) applying FS with 802.11a resolves almost all contention and interference given the large number of orthogonal channels and, (ii) in scenarios where contention and interference are limited, it is preferable to apply the UA algorithm



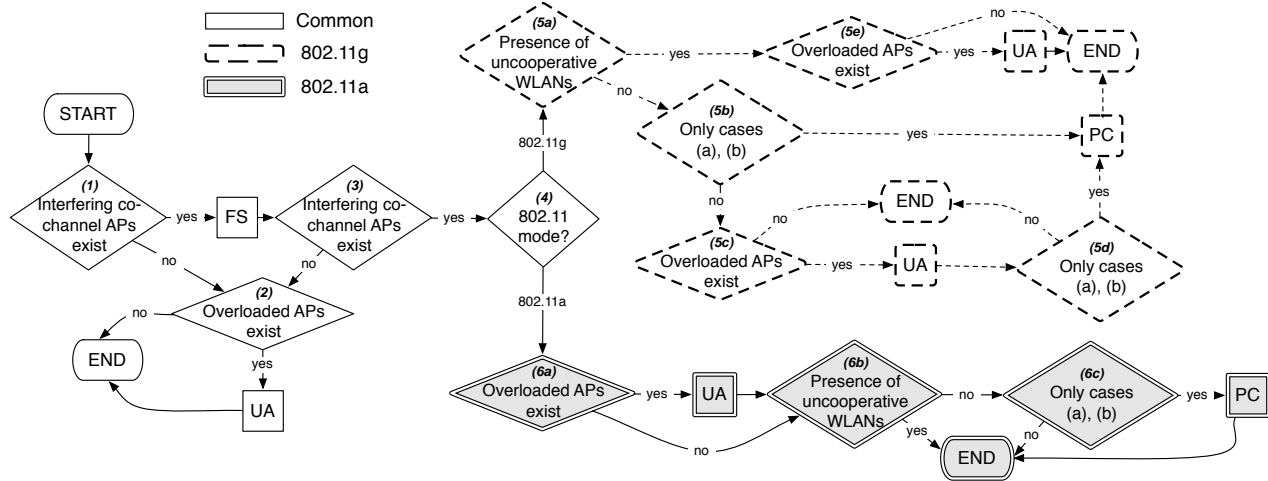

**Figure 10: The MDG framework: design guidelines for both 802.11a and 802.11g. The shaded part corresponds to 802.11a, while the dashed one to 802.11g.**

rather than the PC algorithm. The two observations together, suggest that UA is to be applied in this case if overloaded APs exist; this corresponds to Step (6a). If the loads are perfectly balanced, we directly try to apply the PC algorithm, and proceed to Step (6b), which we discuss below. If UA is applied, it is possible that PC can be subsequently applied; at Step (6c) we check to see if all the links conform to either case (a) or case (b) (as discussed in Section 3) and if this is the case, we apply PC.

**The case for 802.11g: Steps (5b), (5c) and (5d).** The key observations that drive the states in this part of the flow chart are: (i) due to the limited number of orthogonal channels in the 2.4 GHz band, FS is not expected to eliminate contention and interference in high-density deployments with 802.11g and (ii) the use of PC subsequent to FS helps in significantly improving performance with 802.11g. Based on these observations, we apply PC (in lieu of UA) right after FS. However, since contention and interference are at high levels even after the use of FS in 802.11g, we first have to determine if the co-channel APs can shrink their cells, i.e., if PC will provide non-default power/CCA settings (step (5b) in the flow chart). Note that PC may not be able to shrink the cells, for every channel. Thus, we apply the PC algorithm only on those channels where PC can be beneficial. If PC is not expected to provide any benefits on any channel, we proceed to consider the UA algorithm at step (5c). If there is an imbalance in the user associations across APs and UA is applied, the topology changes and may now become conducive for PC. Thus, we check if PC can be applied, again, at step 5(d).

**Accounting for the presence of other WLANs: Steps (5a) and (6b).** So far we have assumed that all the WLANs in the deployment apply MDG. However, in a real environment, we expect the existence of WLANs that do not follow MDG, or are not willing to cooperate. The interference from these collocated WLANs will influence the decision process. In this case, the algorithms will operate as follows:

- **FS:** Each AP will take into account the signal strength received from all co-channel APs (not only the APs belonging to the considered network).
- **UA:** The clients belonging to our network associate with APs of a certain ESSID. Hence, they will not affiliate with other

networks. If there exist other co-channel WLANs, then the medium access time available to an AP is lower than what can be achieved in the absence of these WLANs. This affects the metric that each client computes for its neighbor APs.

- **PC:** If other WLANs are not running PC, then invoking power control in our network could affect both networks. This is due to possible reduction in the transmission power and/or the increase in the CCA threshold in our network. The reduction in power could hurt the clients in our network; with an increase in the CCA threshold the APs in our network could potentially ignore transmissions from the other network and cause user starvation. Thus, the application of PC is precluded if other uncontrolled WLANs exist in the vicinity. This is accounted for in Steps (5a) and (6b).

## 5. VALIDATING OUR GUIDELINES

Our next step is to validate our design guidelines on a completely different network (which we refer to as Testbed B). The primary purpose of our validation process is to determine if our design recommendations allow a different wireless network (arbitrary except for identical hardware and software configuration) to operate at high performance levels using an automated procedure, such as MDG. We first describe Testbed B and subsequently describe our validation process.

### 5.1 Description of the second experimental network

Testbed B is deployed in the third floor of the Engineering Building U-2, at the University of California, Riverside. The deployment is depicted in Fig. 11. While Testbed B has the *same hardware and software configuration* as that of Testbed A, it is considerably different in terms of the network layout and the topology; the environmental conditions are also significantly different from that in the latter case. In particular, Testbed B differs from Testbed A in the following aspects:

1. **Network scale:** It consists of 8 APs and 20 clients; the network is deployed in the 3rd floor of a different building and in a different organization.

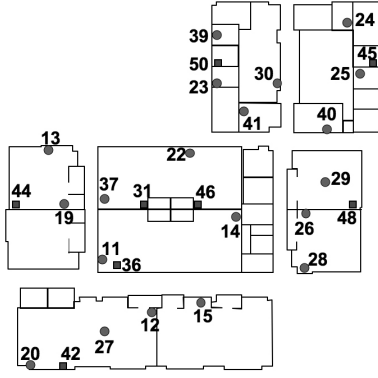

**Figure 11: Deployment of Testbed B. The circles represent the clients, while the squares are the APs.**

2. **Environmental conditions:** The climatic conditions differ; in particular, the temperature is higher and the humidity is much lower. This affects the channel quality [18].
3. **Building materials:** The walls in the second building are supported by thick metallic skeletons, and many of them are made of brick. This degrades the signal strength on a sub-set of the links where no direct line of sight exists. The fading characteristics are also different.
4. **Node locations:** Unlike with Testbed A, the 8 APs are not placed inside network closets given that access was prohibited to many of the building’s facilities. The AP placement strategy however, ensures coverage to the 20 clients.

## 5.2 Validation procedure

We apply the MDG framework on Testbed B in the following way.

- **Calibration:** we provide MDG with a set of input parameters based on a limited set of measurements in Testbed B.
- **Application:** we follow the guidelines from the framework, with regards to which algorithms to enable.
- **Performance evaluation:** we measure the network capacity.

For comparison, we try all other possible combinations of the algorithms, and compare their performance against what is achieved by following the guidelines from MDG. In these experiments, we again assume fully-saturated downlink UDP traffic. Furthermore, we repeat the validation during different hours of the day and on different days. Overall, using MDG provides the best network performance, as we discuss below.

**a. The case for 802.11a.** From our initial measurements on the network (used to calibrate and apply our guidelines), we observe that: (i) There exists a pair of contending APs that share the same channel (AP50 and AP31 are on channel 64). (ii) AP50 has two more clients than AP31, and AP42 has two more clients than AP44.

Given these observations, we follow the flow diagram in Fig. 10 to determine and apply the right choice of algorithms. Since there are contending APs on at least one channel, we run the FS algorithm, as per step (1), and we proceed to step (3) in the flow diagram. We observe that FS has isolated all cells using a set of 5 orthogonal channels. Hence, we go to step (2), as per the flow diagram. Since AP50 has two more clients than AP31, we further apply the UA algorithm. Consequently, the path that we follow in the flow chart is:  $1 \rightarrow FS \rightarrow 3 \rightarrow 2 \rightarrow UA$ . Fig. 12 depicts

the observed performance, in terms of overall network throughput. We compare the results with all other paths through the flow chart (each possibility is represented by the steps that are followed in the flow diagram) and observe that the use of the guidelines yields the best performance results.

Since the channel conditions may change with time, the above procedure must be repeated. The frequency of repetition depends on the extent to which the environment is static. We would expect that the MDG input measurements could be collected at frequent intervals. Reconfiguration should, however, balance the incremental gains against the associated overhead.

We repeated the above procedure (initial measurements for calibration) on a different day and we observed that FS did not completely isolate cells as before. In particular, we observed that: (i) After the convergence of the FS algorithm, the access points AP31 and AP48, (which are in close proximity) selected the same channel (5.32 GHz); (ii) AP50 had 2 more clients than AP31; (iii) AP48 had 4 clients and the RSSI from its farthest client, 40-48, was at -69 dBm, while the RSSI for the AP-AP link 48-31 was at -70 dBm. With this<sup>9</sup>, the flow diagram suggests that we first follow the path:  $1 \rightarrow FS \rightarrow 3 \rightarrow 4 \rightarrow 6a \rightarrow UA \rightarrow 6b$ . At step (6b), after running the UA algorithm, we observed that the client 41 decided to associate with AP45, and that, now AP48 was left with 3 clients; the RSSI from the farthest of these clients was at -44 dBm. As a result, we further proceeded with applying the PC algorithm, as per step (6c). Consequently in this case, the path that we followed in the flow diagram was:  $1 \rightarrow FS \rightarrow 3 \rightarrow 4 \rightarrow 6a \rightarrow UA \rightarrow 6b \rightarrow 6c \rightarrow PC$ . Fig. 13 depicts the performance enhancements in terms of overall network throughput. As in the previous case, the set of steps derived from our flow diagram (*the top stripe*) yields the best performance (as compared to any other possible sequence of actions). Moreover, notice that the resulting network capacity exceeds that of Figure 12.

**b. The case for 802.11g.** As in the case of 802.11a, we begin with a set of preliminary measurements that are used to drive the flow diagram. This set of measurements indicates that: (i) There are many co-channel APs. (ii) AP50, AP48 and AP42 have two more clients than all other APs. (iii) AP50 and AP48 each have a very poor link with one of their clients, and the links fall under case (c).

By following our guidelines, we start at step (1), in the flow diagram, and proceed to step (3), wherein we observe that there are four interfering APs on channel 1 (APs 42, 44, 46 and 48), two on channel 6 (APs 50 and 31), and two non-interfering APs on channel 11 (APs 36 and 45). Thus, we further go to step (4) of the flow diagram; since we use 802.11g, we visit step (5a). Since AP48 and AP50 maintain client links that fall under case (c), we do not run the PC algorithm, but proceed to step (5c). Since some APs have two more clients than others, we run the UA algorithm, and further go to step (5d). Here we observe that, after the UA convergence, all AP-AP links are much weaker than all AP-client links, on channel 1. However, on channel 11 this is not the case. Hence, we apply the PC algorithm only on channel 1. Note that in this case, we make different decisions for the different channels. For channel 1 the path that we follow is:  $1 \rightarrow FS \rightarrow 3 \rightarrow 4 \rightarrow 5a \rightarrow 5b \rightarrow 5c \rightarrow UA \rightarrow 5d \rightarrow PC$ . The paths followed for the other two channels are similar to the first; however, we stop after applying the UA algorithm. Fig. 14 plots the network performance with the steps recommended by our guidelines (*the top stripe*); it also depicts the performance when following any other decision path. We conclude

<sup>9</sup>Note that this procedure was performed late at night; thus the presence of other co-channel WLANs did not cause any starvation problems to our nodes.

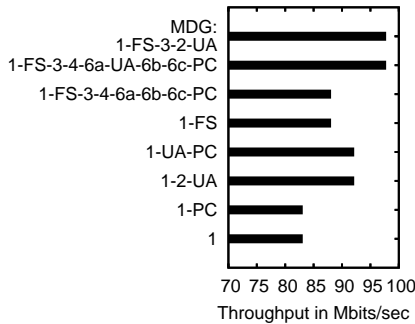

Figure 12: Comparison between the decision of the flow chart, and all other potential possibilities for 802.11a.

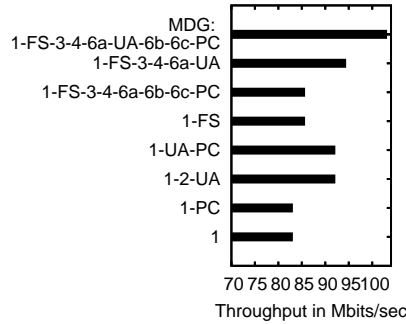

Figure 13: Predominance of flow chart’s decision, for the case wherein the FS algorithm does not isolate all cells, in 802.11a.

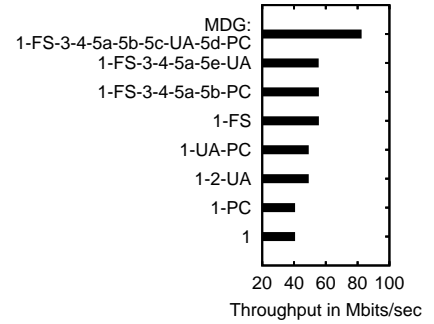

Figure 14: Comparison between the flow chart’s decision, against any other potential steps, for the case of 802.11g.

that our method outperforms any other potential order with different combinations specifying which algorithms to apply and when. In Testbed B, in the case of 802.11g, the performance improvement with MDG, as compared to the default case, is 103%. In this case, due to the limited number of orthogonal channels, the performance with the default case is really poor. In 802.11a, the improvement with MDG is only 24%; this is because, RCS (default case) yields significant benefits, since the number of APs is smaller than the available channels.

### 5.3 Evaluating MDG in the presence of external interference

In the last set of our experiments, we have two objectives. First, we wish to study the performance of MDG in the presence of external interferers. Second, we seek to determine how good the performance of the MDG-derived network configuration is compared to any other possible network configuration (in terms of frequency, power, and user associations). Towards our first objective, we perform a new series of experiments with 802.11g on testbed B, during regular business hours. To fulfil our second goal, we consider 40 randomly perturbed network configurations with regards to our three dimensions i.e., frequency, user association space and power. Specifically, we set-up each experiment as follows:

- Each AP randomly selects an orthogonal channel.
- Each client randomly affiliates with a neighbor AP.
- Each AP randomly sets its transmission power and CCA threshold, while verifying that the connectivity to its clients is maintained and that the product of CCA and power remains constant across the network. This is because we want to ensure that there are no starvation effects due to asymmetry [2].
- Each client uses the same values of transmission power and CCA, as its affiliated AP.

We further run experiments in the same way, as described in section 3. Fig. 15 presents the performance with MDG and with a set of the 10 best random network configurations. To begin with, we observe that external interference was present during our experiments. The network capacity with MDG is reduced by 11%, as compared to the capacity achieved with MDG during overnight experiments. Second, we observe that MDG outperforms all other tested network configurations, by at least 43%. However, this is by far not an exhaustive search of all possible network configurations. We are currently in the process of performing a more extensive search.

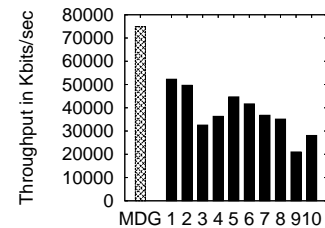

Figure 15: The proper combination of the three algorithms, FS, UA and PC provides the highest benefit, as compared to the 10 best (out of the 40) network configurations.

## 6. VISION, LIMITATIONS AND SCOPE

From the above, it becomes evident that MDG is capable of configuring a dense WLAN by identifying the most promising combination of optimization algorithms.

*The independence of MDG from the specific algorithms.* In this work, we did not consider modifying the optimization algorithms; we only control whether they will be used and in what order. In other words, MDG uses the algorithms as a black box and, thus, it is not intrinsically dependent on them. The fact that FS, UA and PC are all based on a common foundation (Gibbs sampling) does not play a role on MDG. Gibbs sampling is merely a *tool* for distributed optimization, and has no impact on the optimum network configuration. MDG proposes the most efficient order of invocation of the algorithms, and is therefore independent of the actual operations of each of the algorithms. In the future, it is possible to develop better algorithms for each optimization function. MDG would be able to incorporate them with minimal finetuning and adjustments.

*More on the order of optimization dimensions.* In general, channel selection may or may not be a function of user population and user channel gains (e.g., Mishra et al. [10] do a joint channel and user association). However, we believe that if channel selection is performed jointly with user association, then the network configuration could run into stability issues, as client channel gains change much more rapidly than AP-AP gains (e.g., closing of a laptop lid, lifting and moving a PDA, etc). The network-wide channel assignment should not react to such phenomena from the robustness and stability points of view. Hence, we assume that the channel assignment algorithms operate only based on AP-AP channel gains, and not on AP-client gains, or AP-client associations. Note also that PC cannot be applied before UA. This is because PC requires the number of clients associated with each AP as an input. If this num-

ber changes (potentially after the application of UA), PC needs to be applied again.

*Towards an integrated optimization approach.* One can envision a tighter integration, where each algorithm will consider if the other algorithms have already been executed or will be executed. Taking this idea further, one could consider a joint optimization solution for all three dimensions. However, such a solution may not be practical due to the inherently different time-scales of the different algorithms. For example, PC needs to react to user arrivals and should take place more often than FS.

*Overhead and frequency of invocation.* The overall overhead of these algorithms will be largely determined by the frequency with which they are invoked. Note that the three algorithms have inherently different time scales. Frequency selection is likely to be the slowest time scale operation, since changes in the AP occupancy of specific channels is likely to be infrequent. On the other hand, user association and power control are tightly related to user arrivals and departures, as well as user mobility. Clearly, there is a tradeoff between the frequency of their invocation and the optimality of the network configuration. Notice that such optimizations in today's commercial networks happen across multiple hour intervals.

*Convergence Issues.* The overhead of the described algorithms, which are iterative, depends also on their speed of convergence. Our implementation on a prototype platform showed that the overhead of collecting the appropriate measurements and making decisions is not that significant, and a professional implementation would likely eliminate any such overhead. Note that collecting the measurements required by MDG contributes to the overhead, especially since neighborhood information needs to be collected across multiple scanning cycles (as we discussed before). Each scanning cycle is costly, since it precludes data delivery to clients. Therefore, there is a tradeoff between the accuracy of network state provided to MDG and the overhead for collecting it. Fortunately, as stated earlier, our experiments showed that convergence tends to be fast.

## 7. CONCLUSIONS

We design, implement, and evaluate a measurement-driven framework, MDG, which maximizes the synergy between three interdependent optimization dimensions: frequency selection, user association, and power control. In our study, we use three previously designed algorithms for interference mitigation in each dimension, and two distinct wireless testbeds: a learning testbed and a validation testbed. First, we develop an insight for the interdependencies of the optimization algorithms, and identify useful thresholds and conditions of when each algorithm should be applied. This leads us to the MDG framework, which combines the three approaches such that they provide the highest possible benefit compared to any other possible combination.

MDG can be a useful tool for wireless network management in production WLANs. It can operate in an adaptive and distributed way at each AP, or in a centralized fashion, like on a central controller[19]. Note that MDG can be executed by APs that may not belong to the same network, as we discussed earlier, as long as we assume that APs from all networks cooperate.

**Acknowledgements:** We would like to thank Dr. S. Keshav from the University of Waterloo, for his constructive comments on our work.

## 8. REFERENCES

- [1] A. Akella, G. Judd, S. Seshan, and P. Steenkiste. Self-Management in Chaotic Wireless Deployments. In *ACM MOBICOM*, 2005.
- [2] V. Mhatre, K. Papagiannaki, and F. Baccelli. Interference Mitigation through Power Control in High Density 802.11 WLANs. In *IEEE INFOCOM*, 2007.
- [3] B. Kauffmann, F. Baccelli, A. Chaintreau, V. Mhatre, K. Papagiannaki, and C. Diot. Measurement-Based Self Organization of Interfering 802.11 Wireless Access Networks. In *IEEE INFOCOM*, 2007.
- [4] J. Fuemmeler, N. Vaidya, and V. V. Veeravalli. Selecting Transmit Powers and Carrier Sense Thresholds for CSMA Protocols. Technical report, October 2004. University of Illinois at Urbana-Champaign.
- [5] I. Broustis, J. Eriksson, S. V. Krishnamurthy, and M. Faloutsos. A Blueprint for a Manageable and Affordable Wireless Testbed: Design, Pitfalls and Lessons Learned. In *IEEE TRIDENTCOM*, 2007.
- [6] A. Mishra, V. Shrivastava, D. Agarwal, and S. Banerjee. Distributed Channel Management in Uncoordinated Wireless Environments. In *ACM MOBICOM*, 2006.
- [7] J. Geier. Assigning 802.11b Access Point Channels. In *WiFi planet*, 2002.
- [8] P. Bremaud. Markov Chains, Gibbs Field, Monte Carlo Simulation and Queues. Springer-Verlag 1999.
- [9] L. Massoulié and J. Roberts. Bandwidth Sharing: Objectives and Algorithms. *IEEE/ACM Trans. Netw.*, 10(3):320–328, 2002.
- [10] A. Mishra, V. Brik, S. Banerjee, A. Srinivasan, and W. Arbaugh. A Client-Driven Approach for Channel Management in Wireless LANs. In *IEEE INFOCOM*, 2006.
- [11] N. Ahmed and S. Keshav. SMARTA: A Self-Managing Architecture for Thin Access Points. In *ACM CoNEXT*, 2006.
- [12] Soekris-net4826. <http://www.soekris.com/net4826.htm>.
- [13] M. Heusse, F. Rousseau, G. Berger-Sabbatel, and A. Duda. Performance Anomaly of 802.11b. In *IEEE INFOCOM*, 2003.
- [14] S. Vasudevan, K. Papagiannaki, C. Diot, J. Kurose, and D. Towsley. Facilitating Access Point Selection in IEEE 802.11 Wireless Networks. In *ACM IMC*, 2005.
- [15] J. Yee and H. P-Esfahani. Understanding Wireless LAN Performance Tradeoffs. In <http://www.commsdesign.com>, 2002.
- [16] K. Sundaresan and K. Papagiannaki. The Need for Cross-Layer Information in Access Point Selection Algorithms. In *ACM IMC*, 2006.
- [17] V. Mhatre and K. Papagiannaki. Optimal Design of High-Density 802.11 WLANs. In *ACM CoNEXT*, 2006.
- [18] Bhaskar Krishnamachari. *Networking Wireless Sensors*. In *Cambridge University Press*, 2005.
- [19] White paper from Aruba Networks. Advanced RF Management for Wireless Grids. Available at: <http://www.arubanetworks.com/pdf/rf-for-grids.pdf>.